

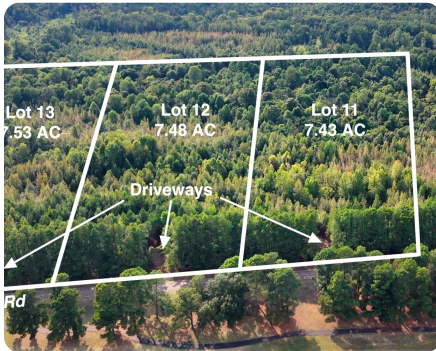

## Millington Residential Lot #12

7.48 +/- Acres | Shelby County, TN | \$114,999



### ADDRESS

0 Bethuel Rd  
Lot 12  
Millington, TN 38053

### LOCATION

From US Highway 51 N in Millington, turn right onto Kerrville Rosemark Rd, cross the railroad tracts and turn left onto Mudville Rd and look for the For Sale sign.

### PROPERTY SUMMARY

Discover the perfect location for your dream home! This expansive 7.48-acre lot offers the serene beauty of rural living coupled with unbeatable proximity to the amenities of Millington. The land presents an ideal canvas for construction, featuring gentle rolling topography with entrance off of Bethuel Road. This property is primed and ready for development: public water, electricity, and natural gas are available at the road, and the site is immediately suitable for septic permitting. Enjoy a prime location right around the corner from the Orgill Golf Course and less than three miles from the Naval Support Activity Base (NSA Mid-South). This acreage provides a rare opportunity to secure a substantial, private retreat that is truly minutes from all the essentials. Build your sanctuary where space and convenience perfectly align.

[nationalland.com/listing/millington-residential-lot-12](https://nationalland.com/listing/millington-residential-lot-12)



National Land Realty  
2298 Young Avenue  
Memphis, TN 38104  
[NationalLand.com](https://NationalLand.com)



**Bill Patton**  
Office: 901-660-5596  
Cell: 901-481-5938  
Fax: 864-331-1610  
[Bpatton@nationalland.com](mailto:Bpatton@nationalland.com)

The above information is from sources deemed reliable, however the accuracy is not guaranteed. National Land Realty assumes no liability for error, omissions or investment results.