

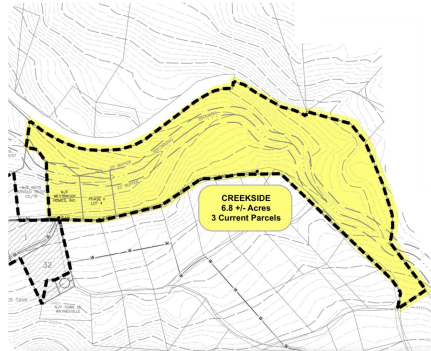

## Three parcel creek front package

6.83 +/- Acres | Haywood County, NC | \$149,000



### ADDRESS

TBD (B) Browning Branch Rd  
Waynesville, NC 28786

### LOCATION

Take Allens Creed Rd South from Waynesville to left on Lickstone Rd. In .7 miles, take a L on Browning Branch Rd. Property will be on right and there is a parking area with the sign after the road turns to gravel.

### PROPERTY SUMMARY

Discover your private mountain creek-front sanctuary with this unrestricted 6.8-acre property featuring lush woodlands, a peaceful valley, and a large creek with cascading waterfalls that flows through it. Just minutes from downtown Waynesville, this secluded 3 parcel option combines privacy with convenience, offering ideal building sites in the valley above the water. The property includes two non-HOA lots in Chestnut Walk Phase II and a larger unrestricted tract. Enjoy easy access to the Blue Ridge Parkway and Pisgah National Forest while immersed in nature's tranquility. The creek's soothing waterfalls create a year-round oasis, perfect for morning coffee or evening strolls. With no HOA restrictions (verify with title search), design your dream cabin, modern retreat, or homestead. A shared gravel road through the property services the Apple Tree community. Rare creek-front opportunity in Haywood County's desirable market. Buyer to verify zoning, utilities, and HOA details.

[nationalland.com/listing/three-parcel-creek-front-package](https://nationalland.com/listing/three-parcel-creek-front-package)



National Land Realty  
13 Lynnette Dr  
Fairview, NC 28730  
[NationalLand.com](https://NationalLand.com)



Pat Snyder  
Office: 828-618-4448  
Cell: 828-761-0841  
Fax: 864-331-1610  
[Psnyder@nationalland.com](mailto:Psnyder@nationalland.com)

The above information is from sources deemed reliable, however the accuracy is not guaranteed.  
National Land Realty assumes no liability for error, omissions or investment results.