

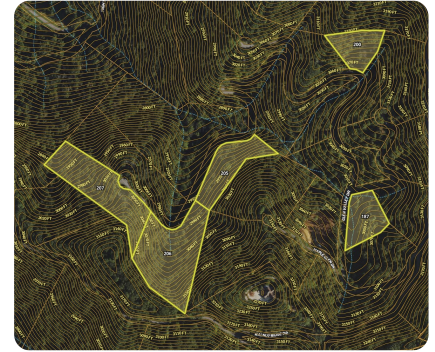

## Five Lot Home Builder Package

11.94 +/- Acres (\$9,422/acre) | Madison County, NC | \$112,500



### ADDRESS

Multiple Lots - Glen Valley Dr  
Weaverville, NC 28787

### LOCATION

Take Exit 15 for NC 197 toward Barnardsville. Turn L on Holcombe Branch Rd just past D&D. Right on Seven Glens Dr. Sharp R on Walnut Ridge Rd, sharp L on Glen Valley Dr. Properties will be on right and left. No Signs, but there are lot number signs.

### PROPERTY SUMMARY

Exceptional 5-lot opportunity priced at a fraction of tax value in the low density Seven Glens community of just over 200 lots across 700 acres. Paved roads & underground power/utilities already in place to simplify your building process. Some lots have driveways graded in and one has a graded home site. Lots 187 has gentle topography, lot 201 has a graded home site, and lots 205/206/207 are contiguous to one another and offer more woodlands/privacy as well as long range views from lot 207. Preliminary soils evaluations for septic are complete (not permits.) The community of Seven Glens has existing home sales from roughly \$500K-\$900K over the past year. Located in Madison County, but just 25 minutes from downtown Asheville, this community strives toward a vision of working together with all residents to offer an inspiring lifestyle and preserve the beauty, safety, and value of their properties and neighborhoods. See <https://www.sevenglenshomeowners.or> for more community information.

[nationalland.com/listing/six-lot-home-builder-package](https://nationalland.com/listing/six-lot-home-builder-package)



National Land Realty  
13 Lynnette Dr  
Fairview, NC 28730  
[NationalLand.com](https://NationalLand.com)



Pat Snyder  
Office: 828-618-4448  
Cell: 828-761-0841  
Fax: 864-331-1610  
[Psnyder@nationalland.com](mailto:Psnyder@nationalland.com)

The above information is from sources deemed reliable, however the accuracy is not guaranteed.  
National Land Realty assumes no liability for error, omissions or investment results.