

SOLD

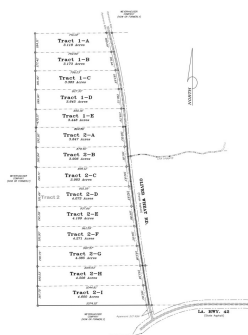

Oliver Wheat Rd. Homesite 2-G

4.38 +/- Acres | Livingston Parish, LA



ADDRESS

2-G Oliver Wheat Rd.
Livingston, LA 70754

LOCATION

Exit I-12 at S Frost Rd. Continue down Hwy 63, turn left onto Hwy 42, and then left onto Oliver Wheat Rd. Lots located on the left. Signs are displayed.

PROPERTY SUMMARY

Oliver Wheat Rd. offers expansive tracts of land tailored for individuals who appreciate seclusion and a serene environment to call home. There's ample space to craft your own personal oasis! Build your dream home, immerse yourself in nature, all while being conveniently close to town amenities. Property is located in the highly regarded Doyle school district. Plenty of space for a workshop, pool, outdoor toys, and equipment. This area is perfect for those that are eager to embrace a lifestyle that values peace and privacy, without sacrificing convenience. Tract 2-G shown on survey as 4.385 Acres.

nationalland.com/listing/oliver-wheat-rd-homesite-lot-6g



National Land Realty
37283 Swamp Road
Unit 702
Prairieville, LA 70769
NationalLand.com



Allison Liuzzo
Office: 225-831-8677
Cell: 225-773-6525
Fax: 864-331-1610
Aliuzzo@nationalland.com

The above information is from sources deemed reliable, however the accuracy is not guaranteed.
National Land Realty assumes no liability for error, omissions or investment results.