

SOLD

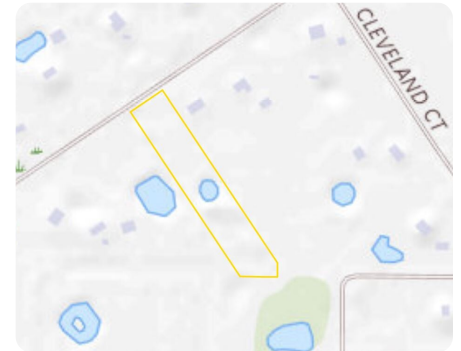

## Punta Gorda Agricultural Homestead Landscaping

3.45 +/- Acres | Charlotte County, FL



### ADDRESS

7824 Cleveland Drive  
Punta Gorda, FL 33982

### LOCATION

From Punta Gorda take Olympia Ave to Hwy 17. Go about 4.5 miles and turn right on Cleveland Dr. Go for about .8 miles and turn right on Cleveland Dr and go about a half a mile. Property will be on your right.

### PROPERTY SUMMARY

Landscaping business opportunity. Discover your ideal rural retreat in Punta Gorda. This versatile property features a charming small cabin with a bathroom, a scenic pond, and lush tropical fruit trees, offering a unique blend of relaxation and productivity. Perfect for a home site, this land also includes a well, septic system for RVs, and electric utilities. Enjoy the benefit of an exception to operate a landscaping business from the property. Located in the desirable Punta Gorda area, you'll appreciate the serene environment while staying close to city conveniences. Agricultural zoning allows for horses, cattle, chickens, and farming. Plus, benefit from the area's renowned schools, vibrant cultural scene, and thriving economy. NO deed restrictions and NO HOA. Whether you're seeking a peaceful retreat or a new place to call home, this property offers the perfect blend of natural beauty and modern convenience easy access to Fort Myers, Sarasota, Arcadia, and Tampa. 3 miles to I-75.

[nationalland.com/listing/punta-gorda-agricultural-homestead-landscaping](https://nationalland.com/listing/punta-gorda-agricultural-homestead-landscaping)



National Land Realty  
2180 West First St  
Unit 301  
Fort Myers, FL 33901  
[Nationalland.com](https://Nationalland.com)



**Justus Koester**  
Office: 239-893-9126  
Cell: 239-898-0163  
Fax: 239-541-8375  
[Jkoester@nationalland.com](mailto:Jkoester@nationalland.com)

The above information is from sources deemed reliable, however the accuracy is not guaranteed.  
National Land Realty assumes no liability for error, omissions or investment results.