

UNDER CONTRACT

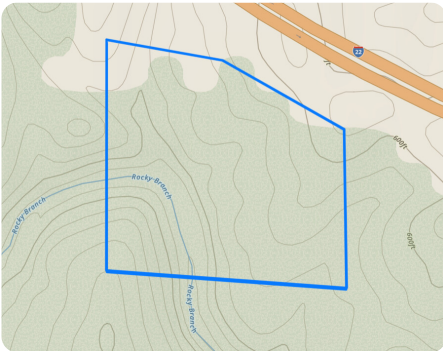

Brilliant Recreation 10

37 +/- Acres (\$1,757/acre) | Marion County, AL | \$65,000



ADDRESS

Tract 10
0 Lady Lane
Brilliant, AL 35548

LOCATION

From the intersection of I 22 and Hwy 129 south of Brilliant, go S on Hwy 129, L on CR 63. Travel 0.7 miles on County Road 63 and turn right onto County Road 391. Drive 0.4 miles and turn left onto Lady Lane. An ATV is needed for the remaining access.

PROPERTY SUMMARY

This recreational tract is loaded with mature timber and habitat for deer and turkey. It is only minutes from Winfield and I 22 and provides a tranquil escape from our busy lives. Deer, turkey, raccoon, and squirrel provide ample hunting opportunities. Other possible uses include camping, hiking, ATV, and horseback riding. Rocky Branch provides fishing and water for wildlife.

nationalland.com/listing/brilliant-recreation-10



National Land Realty
2101 Clinton Avenue West
Suite 301B
Huntsville, AL 35805
Nationalland.com



Billy Rye
Office: 256-459-0745
Cell: 256-810-6876
Fax: 864-331-1610
Brye@nationalland.com

The above information is from sources deemed reliable, however the accuracy is not guaranteed.
National Land Realty assumes no liability for error, omissions or investment results.