

SOLD

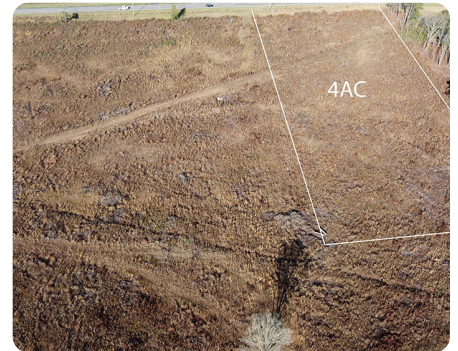

Best 4 Acres

3.86 +/- Acres | Marlboro County, SC



ADDRESS

0 Rogers Lane
Bennettsville, SC 29512

LOCATION

Hwy 38 1/4 mile West of Rogers
Lane, Bennettsville, SC

PROPERTY SUMMARY

This gently rolling homesite along Highway 38 sits just outside of Bennettsville offering beautiful views downhill. Great wildlife with Turkey and Deer everywhere. Call today to learn more!

nationalland.com/listing/best-4-acres



National Land Realty
669 Marina Drive
Ste B-4
Charleston, SC 29492
Nationalland.com



William Herron-Marshall
Office: 855-384-5263
Cell: 843-245-2639
Fax: 864-331-1610
Cmarshall@nationalland.com

The above information is from sources deemed reliable, however the accuracy is not guaranteed.
National Land Realty assumes no liability for error, omissions or investment results.