

SOLD

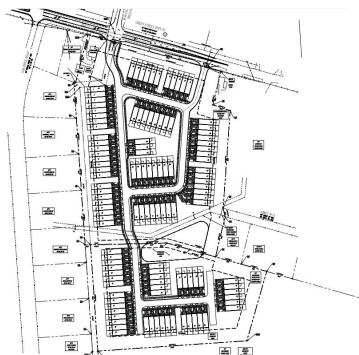

## Burlington Park Townhome Development

13.99 +/- Acres | Franklin County, NC



### ADDRESS

0 NC 56 Highway  
Franklinton, NC 27525

### LOCATION

From I-540 West, take exit 14 to US-1. Travel north for 17 miles. Take the exit for NC-56. The site is located 1.9 miles on the right next to Hey 56 Food Mart.

### PROPERTY SUMMARY

On the northern edge of The Research Triangle Park, lies the Town of Franklinton. Just off US 1, Franklinton is less than a 10-minute drive to North Raleigh, and less than 30 minutes to the I440 beltline. This residential development opportunity sits directly across from one of the largest employers of the county, Novozymes of North America.

At nearly 14 acres, this tract has immediate access to municipal water and sewer. Previously approved for an apartment complex, the seller has plans to submit a new townhome site plan for 120 units (20x55). This site requires no major offsite improvements and has pre-existing zoning approvals (PUD). The seller retains all former field studies from the prior approval.

With nearly 500' of paved road frontage along NC 56 and less than 1 mile into downtown Franklinton, the location is superb. The seller is willing to hold through the site plan approvals and full construction drawings. Call listing agent Cory

[nationalland.com/listing/burlington-park-townhome-development](https://nationalland.com/listing/burlington-park-townhome-development)



National Land Realty  
4221 Sentimental Ln  
Apex, NC 27539  
[NationalLand.com](https://NationalLand.com)



**Cory Bowes**  
Office: 919-646-2455  
Cell: 336-583-5370  
Fax: 864-331-1610  
[Cbowes@nationalland.com](mailto:Cbowes@nationalland.com)

The above information is from sources deemed reliable, however the accuracy is not guaranteed. National Land Realty assumes no liability for error, omissions or investment results.