

Soils Map

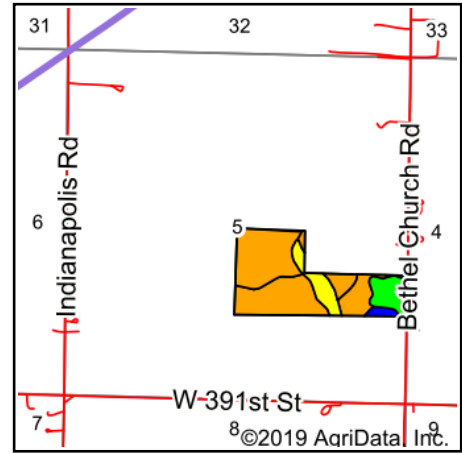

State: **Kansas**
 County: **Miami**
 Location: **5-19S-22E**
 Township: **Mound**
 Acres: **55.54**
 Date:

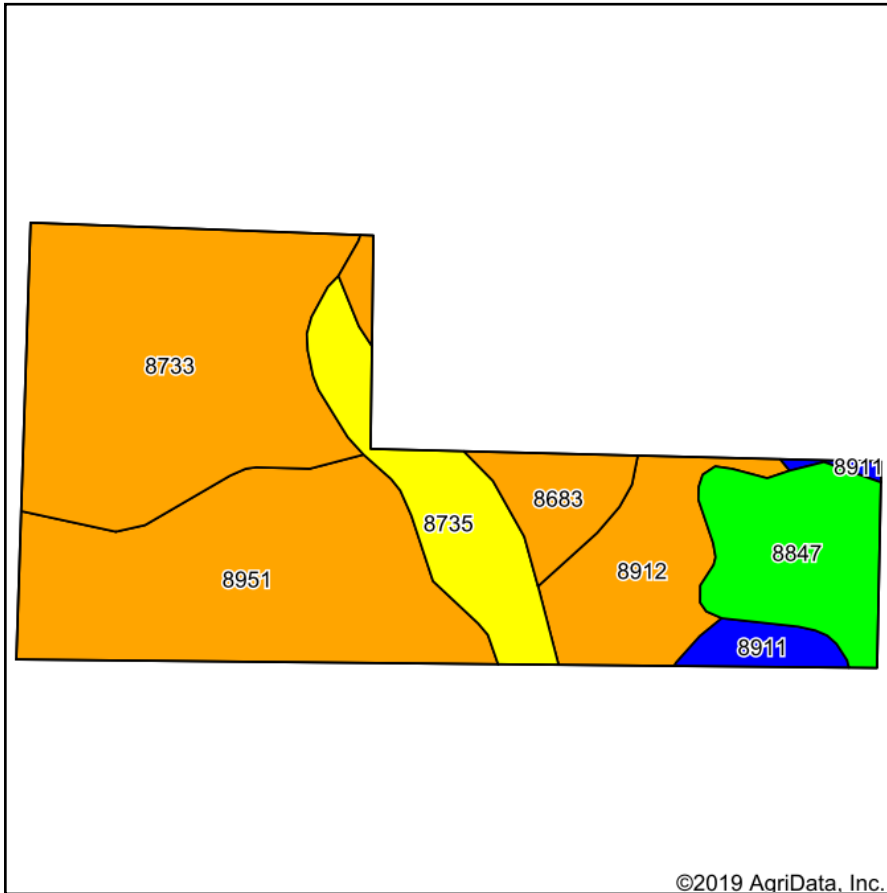

Soils data provided by USDA and NRCS.

Area Symbol: KS121. Soil Area Version: 20									
Cod e	Soil Description	Acres	Percent of field	Non-Irr Class Legend	Non-Irr Class *c	*n NCCPI Overall	*n NCCPI Corn	*n NCCPI Small Grains	*n NCCPI Cotton
8733	Eram silty clay loam, 1 to 3 percent slopes	17.74	31.9%		IIIe	40	40	36	28
8951	Wagstaff silty clay loam, 1 to 3 percent slopes	15.50	27.9%		IIIe	52	37	52	39
8847	Okemah silt loam, 0 to 3 percent slopes	6.11	11.0%		Is	76	71	59	76
8735	Eram silty clay loam, 3 to 7 percent slopes	5.80	10.4%		IVe	41	40	41	36
8912	Summit silty clay loam, 3 to 7 percent slopes	5.78	10.4%		IIIe	59	59	53	56
8683	Dennis silt loam, 3 to 7 percent slopes	3.08	5.5%		IIIe	71	71	53	67
8911	Summit silty clay loam, 1 to 3 percent slopes	1.53	2.8%		Ile	61	56	55	49
Weighted Average						*n 51.7	*n 46.7	*n 46.8	*n 42.8

*n: The aggregation method is "Weighted Average using major components"

*c: Using Capabilities Class Dominant Condition Aggregation Method

Soils data provided by USDA and NRCS.