

NOTE: SURVEYOR HAS MADE NO INVESTIGATION OR INDEPENDENT SEARCH FOR EASEMENTS OF RECORD, ENCUMBRANCES, RESTRICTIVE COVENANTS, OWNERSHIP TITLE EVIDENCE OR ANY OTHER FACTS THAT AN ACCURATE AND CURRENT TITLE SEARCH MAY DISCLOSE.

THE BEARINGS SHOWN ON THIS PLAT ARE BASED UPON GRID NORTH-CA EAST ZONE. GRID NORTH WAS TAKEN FROM GPS NETWORK OBSERVATION. THE BEARINGS SHOWN ON THIS PLAT MAY DIFFER FROM THOSE SHOWN ON PREVIOUS PLATS EVEN THOUGH THE LINES ARE THE SAME.

BOUNDARY SURVEY FOR:
HODGES LIVING TRUST

GRID NORTH - CA EAST ZONE
TAKEN FROM NETWORK OBSERVATION

FLOOD NOTE:
ACCORDING TO FEMA MAP PANEL IDS 13049C0100C, EFFECTIVE DATE 09/25/2009 & 13049C0125D, EFFECTIVE DATE 07/07/2014, FOR CHARLTON COUNTY, A PORTION OF THE AREA SURVEYED LIES IN UNNUMBERED A ZONE, A SPECIAL FLOOD HAZARD AREA. THE APPROXIMATE FLOOD LIMITS SHOWN WERE DERIVED FROM FEMA GIS DATA.

WETLAND NOTE: WETLANDS ARE PRESENT. THE WETLANDS SHOWN ARE DERIVED FROM NMI GIS DATA. NO DELINEATION PERFORMED FOR THE PURPOSE OF THIS SURVEY. WETLANDS ARE UNDER THE JURISDICTION OF THE US ARMY CORE OF ENGINEERS AND MAY NOT BE DISTURBED WITHOUT PROPER PERMITS.

LAND LOT NUMBERS ARE CIRCLED. LOCATIONS OF LAND LOT CORNERS ARE APPROXIMATE.

eFiled & eRecorded
STATE OF GEORGIA
Charlton Superior Court
Clerk: Wendy Whitaker-Lee
03/26/2026 06:02 PM
Plat Book: 02026
Page: 0026
\$10.00 FILING FEES

PAVED ROAD CURVE LINES

Course	Bearing	Distance
C1	Rod: 1569.50'	A: 193.74'
	Tan: 96.99'	CA: 7°04'21"
	Chd: N 55°58'13" E	193.61'
C2	Rod: 973.36'	A: 402.13'
	Tan: 203.97'	CA: 23°40'13"
	Chd: N 64°16'09" E	399.27'
C3	Rod: 1242.47'	A: 577.91'
	Tan: 294.29'	CA: 25°39'00"
	Chd: N 89°25'46" E	572.72'
C4	Rod: 2984.81'	A: 593.10'
	Tan: 297.53'	CA: 11°23'06"
	Chd: S 83°10'09" E	592.13'

WEYERHAEUSER FOREST HOLDINGS, INC.
PB A PG 62
DB 237 PG 377
TAX PARCEL 0070 003
PARENT PARCEL OF AREA SURVEYED

EDGE OF WOODS ROAD LINES

Course	Bearing	Distance
13	N 2°13'45" E	249.90'
14	N 24°13'39" E	219.81'
15	Rod: 400.00'	A: 301.83'
	Tan: 158.51'	CA: 43°14'04"
	Chd: N 46°28'26" E	294.72'
16	N 67°15'06" E	183.38'
17	N 63°37'51" E	235.17'
18	N 59°49'51" E	426.34'
19	Rod: 1206.00'	A: 241.97'
	Tan: 121.39'	CA: 11°29'44"
	Chd: N 64°13'33" E	241.58'
20	N 68°54'23" E	341.52'
21	Rod: 321.00'	A: 312.61'
	Tan: 169.95'	CA: 55°47'54"
	Chd: N 47°02'18" E	300.40'

5/8"RBS AT ROAD CORNERS

AREA= 885.83 ACRES

BOUNDARY LINES

Course	Bearing	Distance
1	N 31°52'04" E	61.86'
2	N 08°18'39" E	80.97'
3	N 1°25'09" E	126.42'
4	N 03°57'32" E	83.80'
5	N 06°00'44" W	89.20'
6	N 21°09'20" W	89.53'
7	N 24°39'35" E	136.97'
8	N 20°35'46" E	274.21'
9	N 52°22'22" W	61.47'
10	N 81°15'50" W	102.16'
11	N 44°23'50" E	96.38'
12	N 51°07'00" E	163.81'

5/8" - 3/4" RBS AT LINE CORNERS

STATE OF GEORGIA
CHARLTON COUNTY
LAND DISTRICT #2
LAND LOTS: 138, 139, 182, 183
PLAT DATE: 19 FEBRUARY 2026
FIELD SURVEY: 18 FEBRUARY 2026
PLAT E.O.C.: 1" IN 1,328,993'

EQUIPMENT USED
CARLSON BRx7
BASE AND ROVER

NOTE: THIS SURVEY WAS PERFORMED USING CARLSON GNSS BASE AND ROVER. MAXIMUM HORIZONTAL TOLERANCE FOR SURVEY CONTROL 0.05" WHICH IS WITHIN 95% CONFIDENCE INTERVAL.

IPS= IRON PIN SET
IPF= IRON PIN FOUND
RBF= REBAR FOUND
RBS= REBAR SET
CMF(R)= CONCRETE MONUMENT FOUND (BROKE)
CMS= CONCRETE MONUMENT SET

SCALE- 1 INCH= 400 FEET
GRAPHIC SCALE
DRAWN BY: ADE
FILE #260209

WEYERHAEUSER FOREST HOLDINGS, INC.
PB A PG 62
DB 237 PG 377
TAX PARCEL 0070 003
PARENT PARCEL OF AREA SURVEYED

THE PROPERTY HEREON LIES COMPLETELY WITHIN A JURISDICTION WHICH DOES NOT REVIEW OR APPROVE ANY PLATS OR THIS TYPE OF PLAT PRIOR TO RECORDING. RECORDATION OF THIS PLAT DOES NOT IMPLY APPROVAL OF ANY LOCAL JURISDICTION, AVAILABILITY OF PERMITS, COMPLIANCE WITH LOCAL REGULATIONS OR REQUIREMENTS, OR SUITABILITY FOR ANY USE OR PURPOSE OF THE LAND. FURTHERMORE, THE UNDERSIGNED LAND SURVEYOR CERTIFIES THAT THIS PLAT COMPLIES WITH THE MINIMUM TECHNICAL STANDARDS FOR PROPERTY SURVEYS IN GEORGIA AS SET FORTH IN THE RULES AND REGULATIONS OF THE GEORGIA BOARD OF REGISTRATION FOR PROFESSIONAL ENGINEERS AND LAND SURVEYORS AND AS SET FORTH IN O.C.G.A. SECTION 15-6-67.

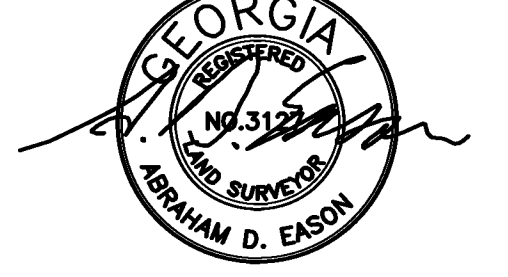

EASON LAND SURVEYING
P.O. BOX 753
CLAXTON, GA. 30417
(912) 739-7143
LSF 000047