

# Soils Map

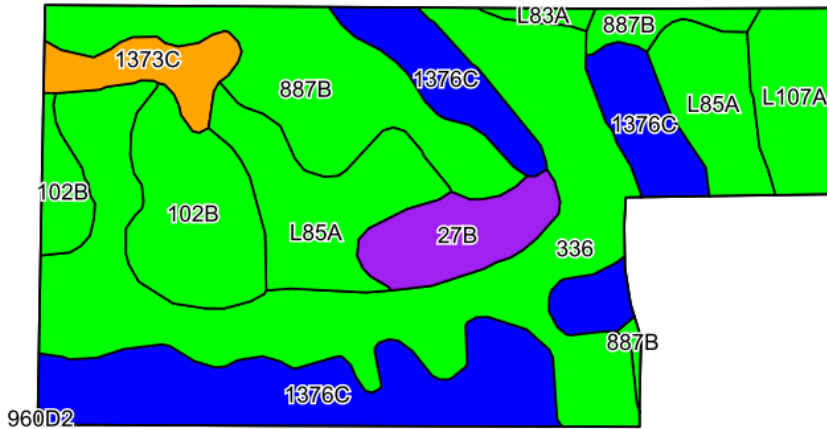

©2026 AgriData, Inc.

Soils data provided by USDA and NRCS.

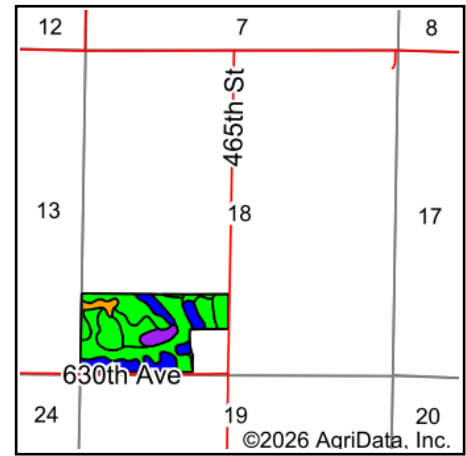

State: **Minnesota**  
 County: **Renville**  
 Location: **18-112N-32W**  
 Township: **Cairo**  
 Acres: **60.38**  
 Date: **1/23/2026**

**NATIONAL LAND REALTY**



Maps Provided By:



© AgriData, Inc. 2025

www.AgriDataInc.com



Area Symbol: MN129, Soil Area Version: 22

Code	Soil Description	Acres	Percent of field	PI Legend	Non-Irr Class *c	Productivity Index
336	Delft clay loam, 0 to 2 percent slopes	16.76	27.8%		IIw	94
1376C	Clarion-Storden complex, 6 to 10 percent slopes, moderately eroded	13.44	22.3%		IIIe	87
887B	Clarion-Swanlake complex, 2 to 6 percent slopes	8.41	13.9%		Ile	92
L85A	Nicollet clay loam, 1 to 3 percent slopes	7.59	12.6%		Iw	99
102B	Clarion loam, 2 to 6 percent slopes	5.88	9.7%		Ile	95
L107A	Canisteo-Glencoe complex, 0 to 2 percent slopes	3.04	5.0%		IIw	91
27B	Dickinson loam, 2 to 6 percent slopes	2.91	4.8%		IIIe	60
1373C	Clarion-Storden-Pilot Grove complex, 6 to 10 percent slopes, moderately eroded	2.03	3.4%		IIIe	73
L83A	Webster clay loam, 0 to 2 percent slopes	0.32	0.5%		IIw	93
<b>Weighted Average</b>					<b>2.18</b>	<b>90.4</b>

\*c: Using Capabilities Class Dominant Condition Aggregation Method

Soils data provided by USDA and NRCS.