

Soils Map

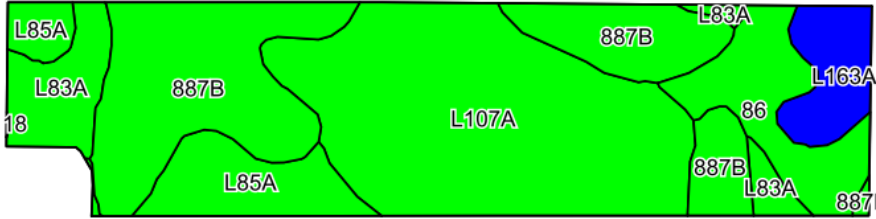

©2025 AgriData, Inc.

Soils data provided by USDA and NRCS.

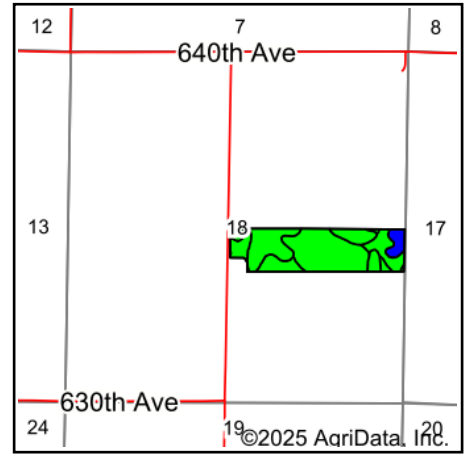

State: **Minnesota**
 County: **Renville**
 Location: **18-112N-32W**
 Township: **Cairo**
 Acres: **37.84**
 Date: **6/10/2025**

NATIONAL LAND REALTY



Maps Provided By:



© AgriData, Inc. 2023

www.AgriDataInc.com



Area Symbol: MN129, Soil Area Version: 21

Code	Soil Description	Acres	Percent of field	PI Legend	Non-Irr Class *c	Productivity Index
L107A	Canisteo-Glencoe complex, 0 to 2 percent slopes	14.41	38.0%		IIw	91
887B	Clarion-Swanlake complex, 2 to 6 percent slopes	11.13	29.4%		IIe	92
86	Canisteo clay loam, 0 to 2 percent slopes	3.69	9.8%		IIw	93
L85A	Nicollet clay loam, 1 to 3 percent slopes	3.60	9.5%		Iw	99
L83A	Webster clay loam, 0 to 2 percent slopes	2.90	7.7%		IIw	93
L163A	Okoboji silty clay loam, 0 to 1 percent slopes	2.11	5.6%		IIIw	86
Weighted Average					1.96	92.1

*c: Using Capabilities Class Dominant Condition Aggregation Method

Soils data provided by USDA and NRCS.