

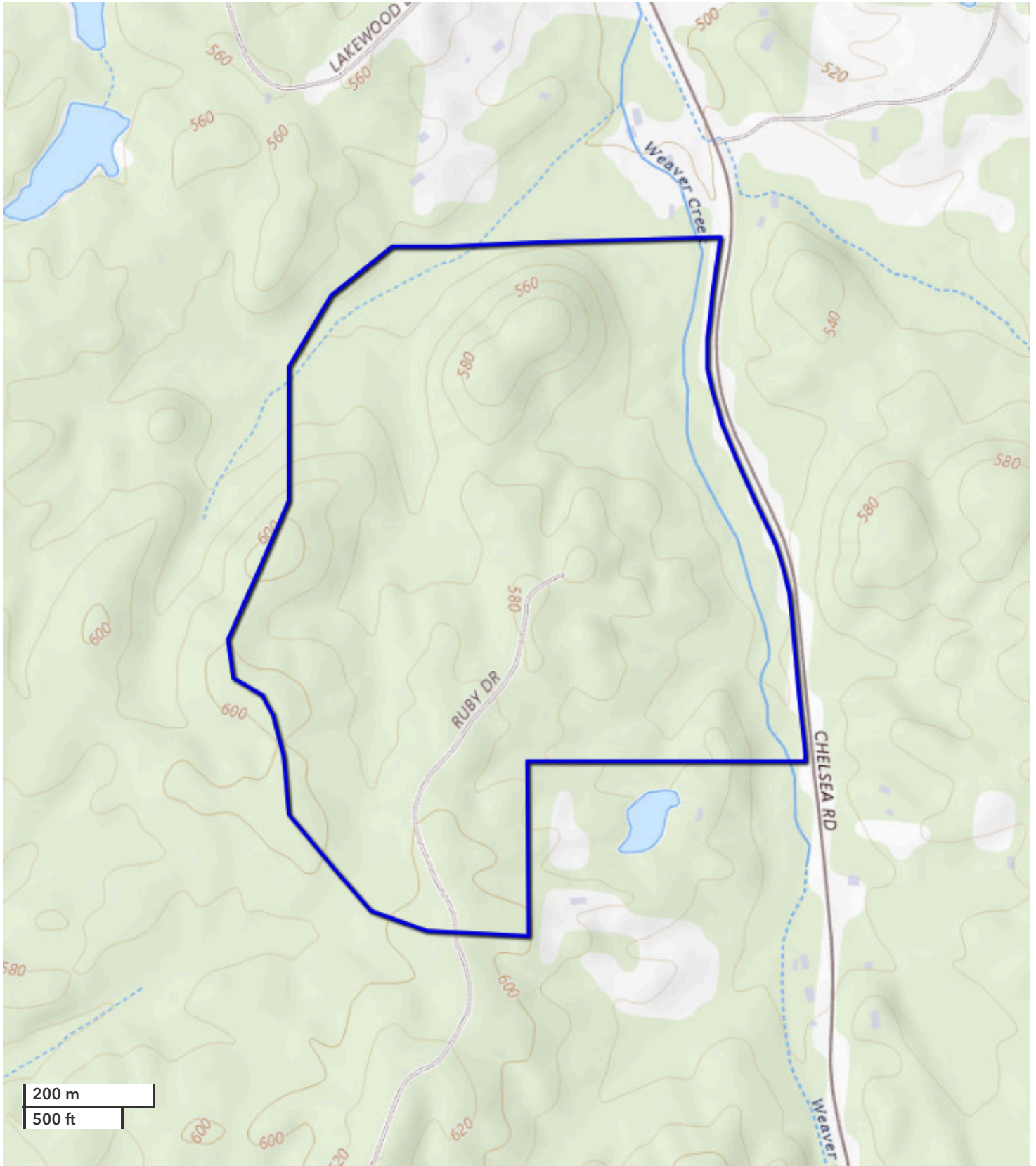

JOHN CONNOR FARMER  
Land Professional  
jcfarmer@nationaland.com  
Mobile: 205-641-0453  
Office: 855-657-5263  
Fax: 888-672-1810

160 Acres with Creek, Pastures & Covered Bridge  
Shelby County, AL  
160 +/- Acres



*All boundary lines noted in pictures, aerials or maps should be considered estimates and not relied on as legal documents or descriptions.*