

# Soils Map

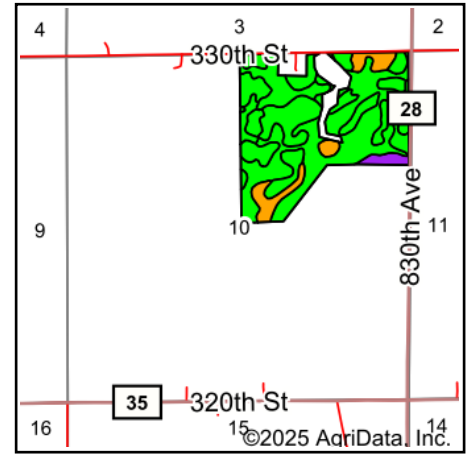

State: **Minnesota**  
 County: **Freeborn**  
 Location: **10-104N-20W**  
 Township: **Geneva**  
 Acres: **109 +/-**  
 Date: **11/7/2025**

**NATIONAL**  
**LAND**  
**REALTY**

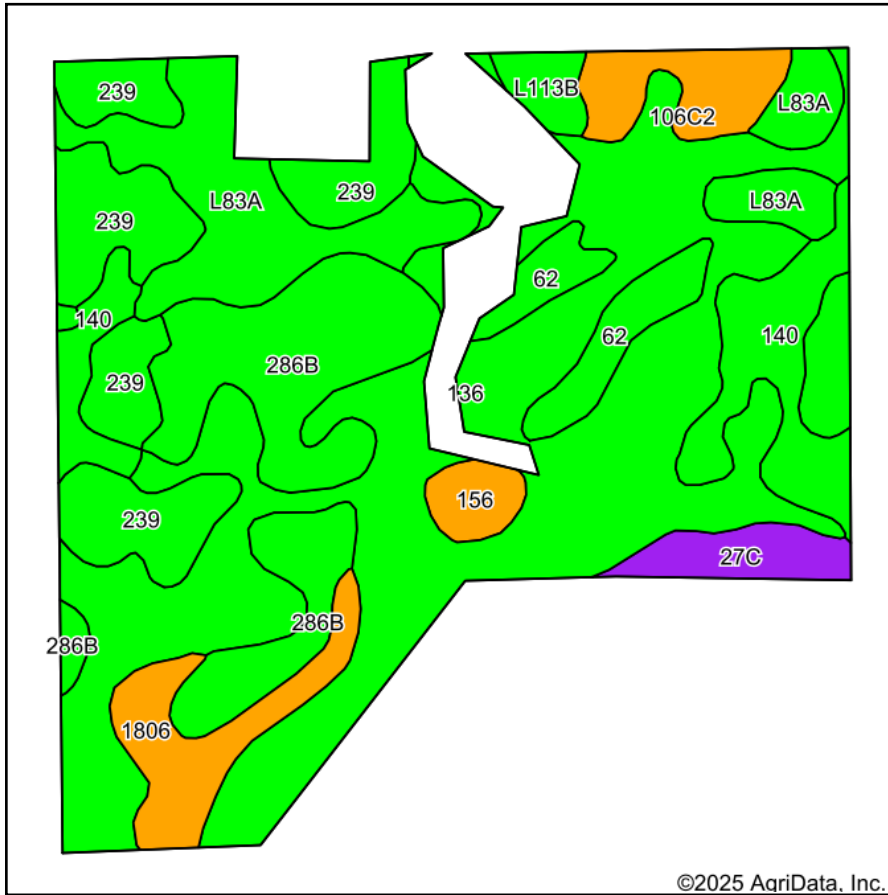

Maps Provided By:



© AgriData, Inc. 2023

www.AgriDataInc.com



Area Symbol: MN047, Soil Area Version: 21

Code	Soil Description	Acres	Percent of field	PI Legend	Non-Irr Class *c	Productivity Index
136	Madelia silty clay loam, 0 to 2 percent slopes	43.84	40.4%		IIw	94
286B	Shorewood silty clay loam, 1 to 6 percent slopes	14.00	12.8%		IIe	95
239	Le Sueur loam, 1 to 3 percent slopes	13.56	12.4%		Iw	97
L83A	Webster clay loam, 0 to 2 percent slopes	11.87	10.9%		IIw	93
140	Spicer silty clay loam, 0 to 2 percent slopes	7.99	7.3%		IIw	91
1806	Lerdal silty clay loam, silty substratum, 0 to 2 percent slopes	4.81	4.4%		IIw	80
62	Barrington silt loam, 1 to 3 percent slopes	4.03	3.7%		Iw	94
106C2	Lester loam, 6 to 10 percent slopes, moderately eroded	3.46	3.2%		IIIe	76
27C	Dickinson fine sandy loam, 6 to 16 percent slopes	2.54	2.3%		IVe	55
156	Fairhaven loam, 0 to 2 percent slopes	1.54	1.4%		IIIs	78
L113B	Reedslake-Le Sueur complex, 1 to 6 percent slopes	1.36	1.2%		IIe	98
<b>Weighted Average</b>					<b>1.92</b>	<b>91.9</b>

\*c: Using Capabilities Class Dominant Condition Aggregation Method