

Soils Map

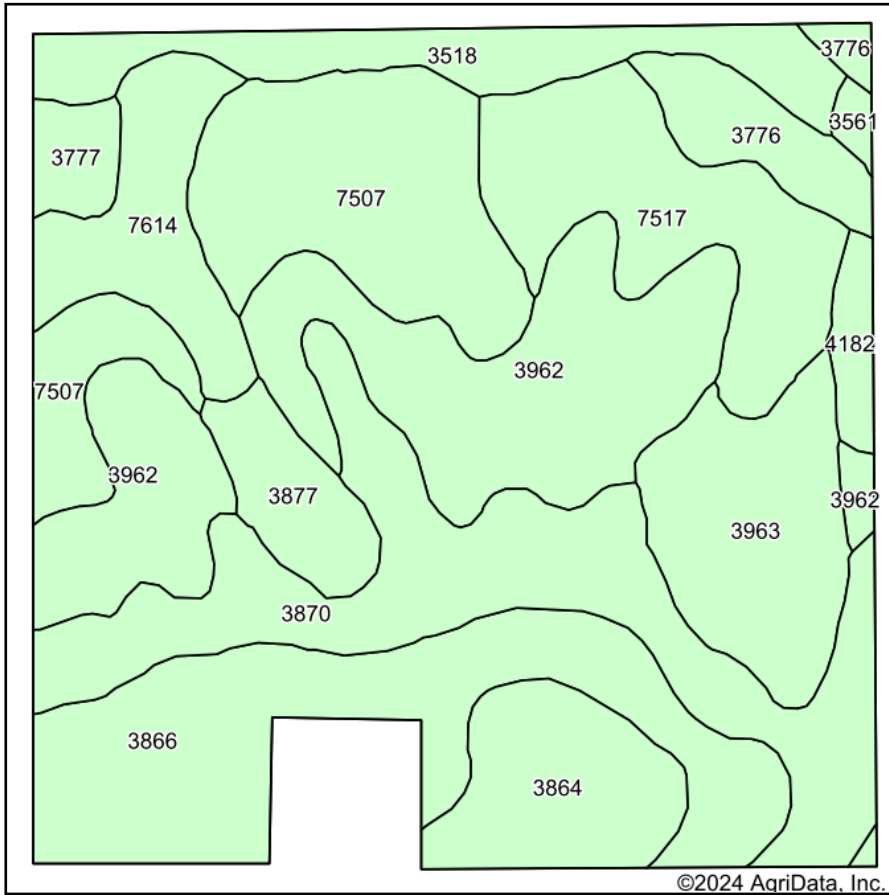

©2024 AgriData, Inc.

Soils data provided by USDA and NRCS.

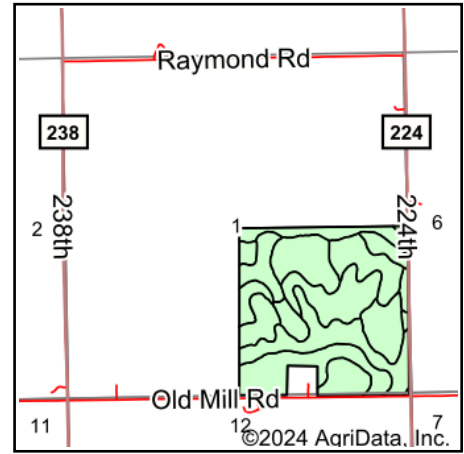

State: **Nebraska**
 County: **Seward**
 Location: **1-11N-3E**
 Township: **Precinct G**
 Acres: **151.91**
 Date: **5/2/2024**

NATIONAL LAND REALTY

Maps Provided By:



© AgriData, Inc. 2023

www.AgriDataInc.com



Area Symbol: NE159, Soil Area Version: 23

Code	Soil Description	Acres	Percent of field	Water Table	Non-Irr Class *c	Range Production (lbs/acre/yr)	SRPG	Alfalfa hay Tons	Corn Bu	Grain sorghum Bu	Soybeans Bu	Winter wheat Bu	*n NCCPI Overall	*n NCCPI Corn	*n NCCPI Small Grains	*n NCCPI Soybeans
3962	Hastings silty clay loam, 7 to 11 percent slopes, eroded	25.59	16.8%	> 6.5ft.	Ive	3226	65						57	56	56	56
3870	Hastings silty clay loam, 3 to 7 percent slopes, eroded	22.98	15.1%	> 6.5ft.	IIle	3727	71						58	57	57	58
3866	Hastings silt loam, 1 to 3 percent slopes	21.06	13.9%	> 6.5ft.	Ile	3807	74						67	62	62	67
7507	Pawnee clay loam, 6 to 11 percent slopes, eroded	19.00	12.5%	1.2ft.	Ive	3750	50						44	38	44	39
7517	Pawnee soils, 6 to 11 percent slopes, severely eroded	13.39	8.8%	1.2ft.	Vle	3750	45						42	36	42	33

Soils data provided by USDA and NRCS.



Code	Soil Description	Acres	Percent of field	Water Table	Non-Irr Class *c	Range Production (lbs/acre/yr)	SRPG	Alfalfa hay Tons	Corn Bu	Grain sorghum Bu	Soybeans Bu	Winter wheat Bu	*n NCCPI Overall	*n NCCPI Corn	*n NCCPI Small Grains	*n NCCPI Soybeans
3963	Hastings silty clay loam, 7 to 11 percent slopes, severely eroded	11.16	7.3%	> 6.5ft.	Ive	3900	65	4	72	69	35	36	55	54	55	53
3518	Lamo silty clay loam, occasionally flooded	8.75	5.8%	1.5ft.	IIw	6174	56	5	79	81	41	41	67	54	47	67
3864	Hastings silt loam, 0 to 1 percent slopes	8.26	5.4%	> 6.5ft.	Iw	3953	75						68	64	63	68
7614	Steinauer clay loam, 6 to 11 percent slopes, eroded	7.88	5.2%	> 6.5ft.	Ive	2925	46						61	55	51	61
3776	Muir silt loam, 1 to 3 percent slopes	4.86	3.2%	> 6.5ft.	Ile	3600	75						79	74	70	79
3877	Hastings silty clay loam, 11 to 17 percent slopes, severely eroded	4.43	2.9%	> 6.5ft.	Vle	3900	57						52	51	52	48
3777	Muir silt loam, 3 to 7 percent slopes	2.14	1.4%	> 6.5ft.	IIle	3600	75						79	73	69	79
4182	Longford silty clay loam, 7 to 11 percent slopes, eroded	1.81	1.2%	> 6.5ft.	Ive	3060	64						56	54	56	54
3561	Hobbs silt loam, occasionally flooded	0.60	0.4%	> 6.5ft.	IIw	4235	71						80	65	60	80
Weighted Average					3.44	3776.2	62.8	0.6	9.8	9.7	4.9	5	*n 57.8	*n 53.8	*n 54.3	*n 55.9

*n: The aggregation method is "Weighted Average using all components"

*c: Using Capabilities Class Dominant Condition Aggregation Method