

# Soils Map

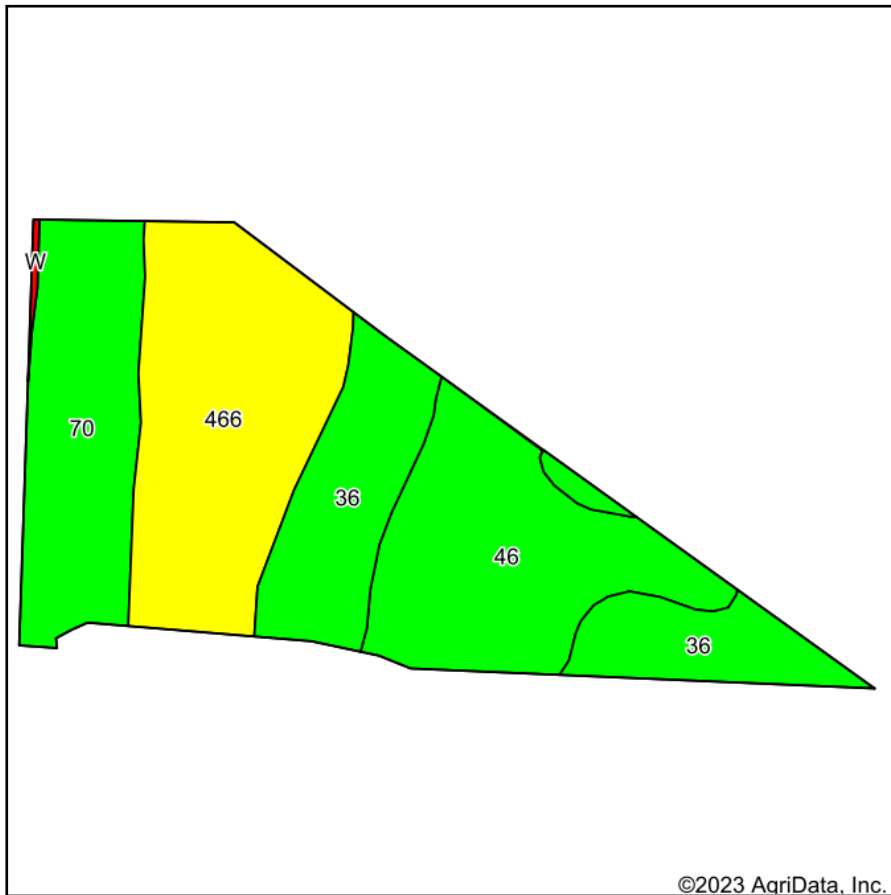

©2023 AgriData, Inc.

Soils data provided by USDA and NRCS.

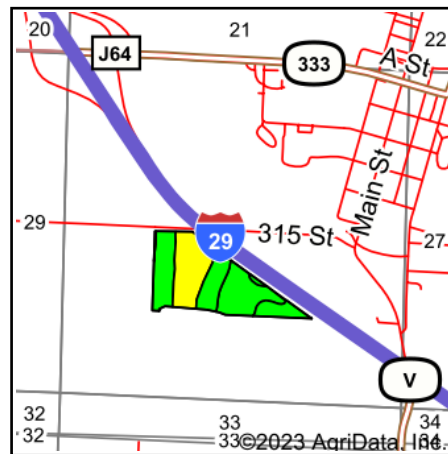

State: **Iowa**  
 County: **Fremont**  
 Location: **28-67N-42W**  
 Township: **Washington**  
 Acres: **42.88**  
 Date: **5/16/2023**



Maps Provided By:



© AgriData, Inc. 2023

www.AgriDataInc.com



Area Symbol: IA071, Soil Area Version: 29

| Code                    | Soil Description      | Acres | Percent of field | CSR2 Legend | Water Table | Non-Irr Class *c | CSR2**    | CSR         | *n NCCPI Overall | *n NCCPI Corn | *n NCCPI Small Grains | *n NCCPI Soybeans |              |
|-------------------------|-----------------------|-------|------------------|-------------|-------------|------------------|-----------|-------------|------------------|---------------|-----------------------|-------------------|--------------|
| 466                     | Solomon clay          | 13.04 | 30.4%            | Yellow      | 0ft.        | Illw             | 57        | 35          | 48               | 40            | 14                    | 48                |              |
| 46                      | Keg silt loam         | 10.82 | 25.2%            | Green       | > 6.5ft.    | lw               | 98        | 90          | 81               | 77            | 62                    | 81                |              |
| 36                      | Salix silty clay loam | 10.14 | 23.6%            | Green       | 4ft.        | lw               | 98        | 90          | 95               | 77            | 63                    | 95                |              |
| 70                      | McPaul silt loam      | 8.75  | 20.4%            | Green       | 4ft.        | lw               | 71        | 85          | 86               | 71            | 55                    | 86                |              |
| W                       | Water                 | 0.13  | 0.3%             | Red         | > 6.5ft.    |                  | 0         | 0           |                  |               |                       |                   |              |
| <b>Weighted Average</b> |                       |       |                  |             |             |                  | <b>*-</b> | <b>79.7</b> | <b>72</b>        | <b>*n 75</b>  | <b>*n 64.3</b>        | <b>*n 46</b>      | <b>*n 75</b> |

\*\*IA has updated the CSR values for each county to CSR2.

\*n: The aggregation method is "Weighted Average using all components"

\*c: Using Capabilities Class Dominant Condition Aggregation Method

\*- Non Irr Class weighted average cannot be calculated on the current soils data due to missing data.

Soils data provided by USDA and NRCS.