

# Soils Map

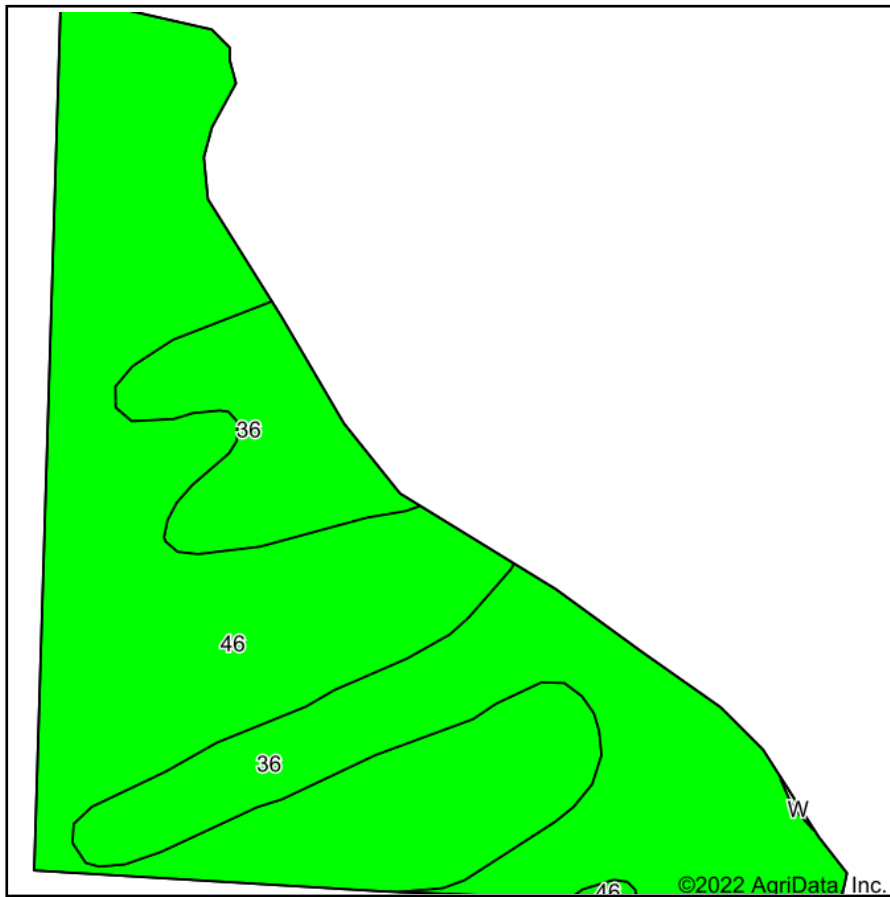

Soils data provided by USDA and NRCS.

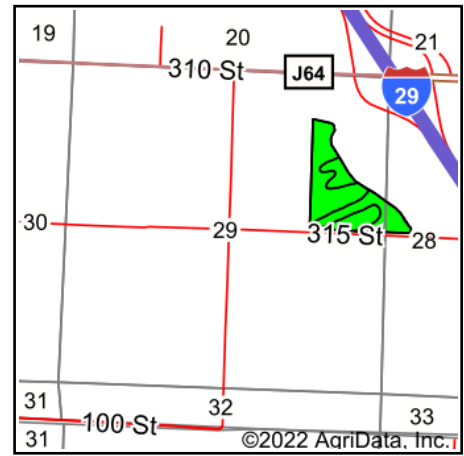

State: **Iowa**  
 County: **Fremont**  
 Location: **29-67N-42W**  
 Township: **Washington**  
 Acres: **35.37**  
 Date: **6/30/2022**

**NATIONAL  
LAND  
REALTY**

Maps Provided By:

**surety**  
 CUSTOMIZED ONLINE MAPPING  
 © AgriData, Inc. 2021 www.AgriDataInc.com



Area Symbol: IA071, Soil Area Version: 28

Code	Soil Description	Acres	Percent of field	Non-Irr Class Legend	Water Table	Non-Irr Class *c	CSR2**	CSR	*n NCCPI Overall	*n NCCPI Corn	*n NCCPI Small Grains	*n NCCPI Soybeans
46	Keg silt loam	21.88	61.9%		> 6.5ft.	lw	98	90	82	77	62	82
36	Salix silty clay loam	13.49	38.1%		4ft.	lw	98	90	96	78	63	96
Weighted Average						1.00	98	90	*n 87.3	*n 77.4	*n 62.4	*n 87.3

\*\*IA has updated the CSR values for each county to CSR2.

\*n: The aggregation method is "Weighted Average using all components"

\*c: Using Capabilities Class Dominant Condition Aggregation Method

Soils data provided by USDA and NRCS.