

Soils Map

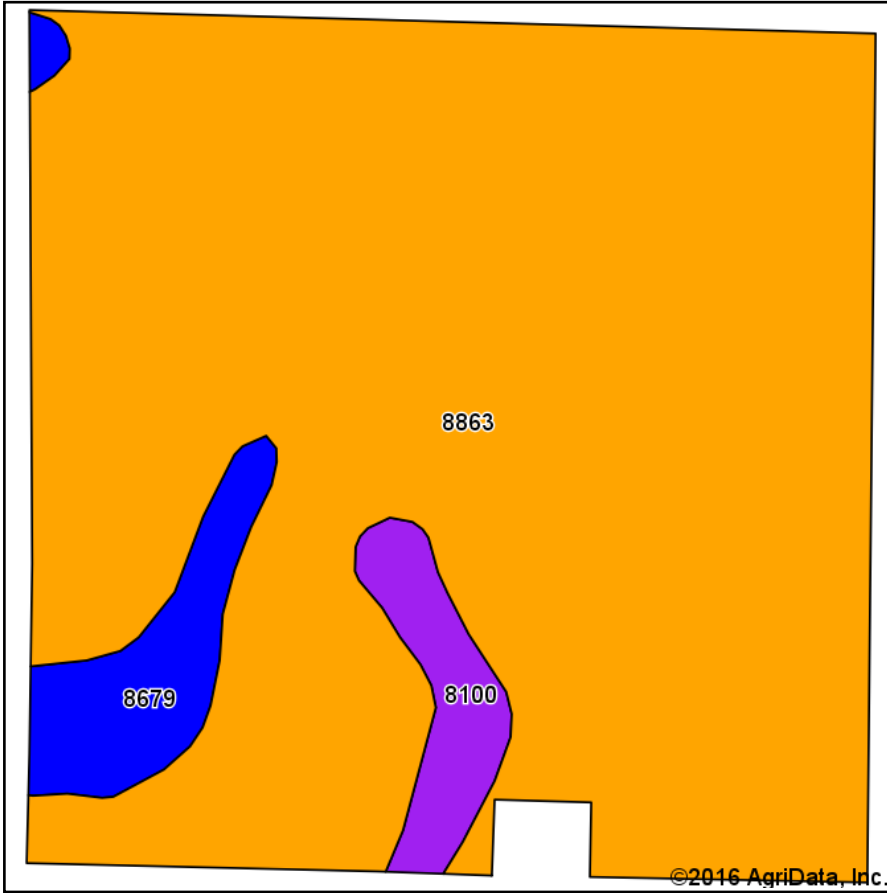

Soils data provided by USDA and NRCS.

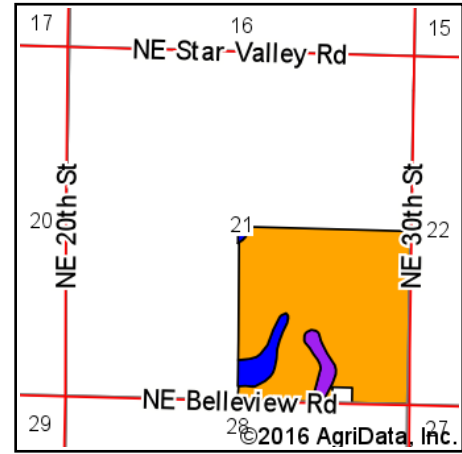

State: **Kansas**
 County: **Cherokee**
 Location: **21-32S-24E**
 Township: **Mineral**
 Acres: **159.02**
 Date: **5/31/2016**



Maps Provided By:



© AgriData, Inc. 2016

www.AgriDataInc.com



Area Symbol: KS021, Soil Area Version: 15

Code	Soil Description	Acres	Percent of field	Non-Irr Class Legend	Non-Irr Class *c	*n NCCPI Overall
8863	Parsons silt loam, 0 to 1 percent slopes	145.05	91.2%		Illw	75
8679	Dennis silt loam, 1 to 3 percent slopes	8.23	5.2%		Ile	74
8100	Hepler silt loam, 0 to 3 percent slopes, frequently flooded	5.74	3.6%		Vw	61
Weighted Average						*n 74.4

Area Symbol: KS021, Soil Area Version: 15

*n: NCCPI updated on 1-25-2016

*c: Using Capabilities Class Dominant Condition Aggregation Method

Soils data provided by USDA and NRCS.